

LTR	DATE MM\DD\YY	BY	CHK'D	PROVE OUT	PROD APPR	REVISION
B	4-19-07	R.E	AMW	--	TLO	SEE TIF FILES FOR PREV. REVS; REVISED GEN NOTE 1; ADDED -1 VARIANT (ER# 32458)
C	9-18-12	RRK	ALO	--	TLO	REVISED FLAG NOTE 1. ZINC III CLEAR WAS ZINC 2 YELLOW CHROMATE. (ER-MIN4741; EC-PUR1684)
D	8-13-15	ALO	RRK	--	TLO	ADDED GEN NOTES 3 AND 4, +0.00 / -0.08 WAS +0.0051 / -0.038. (ER-MIN5209; EC-PUR2148)

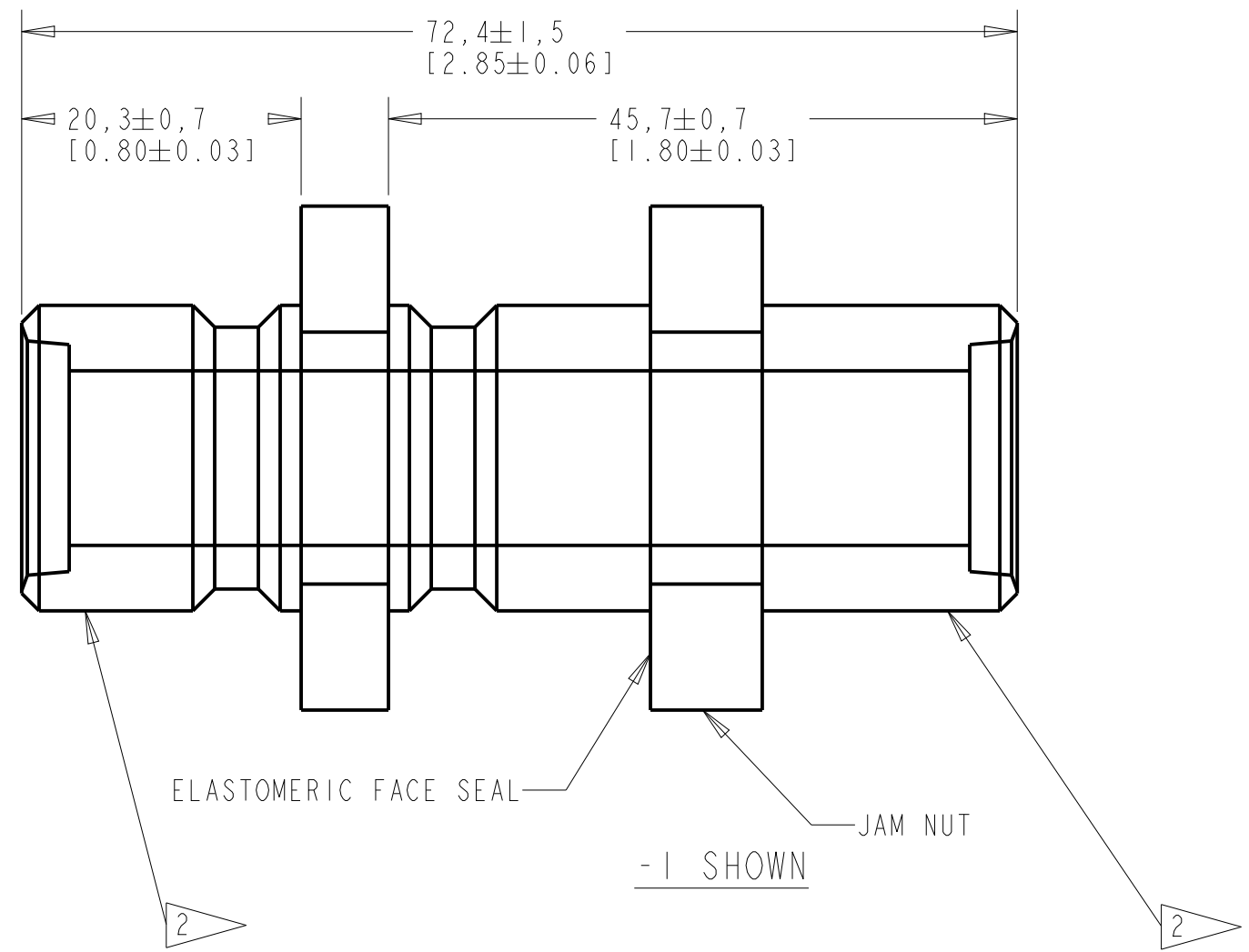
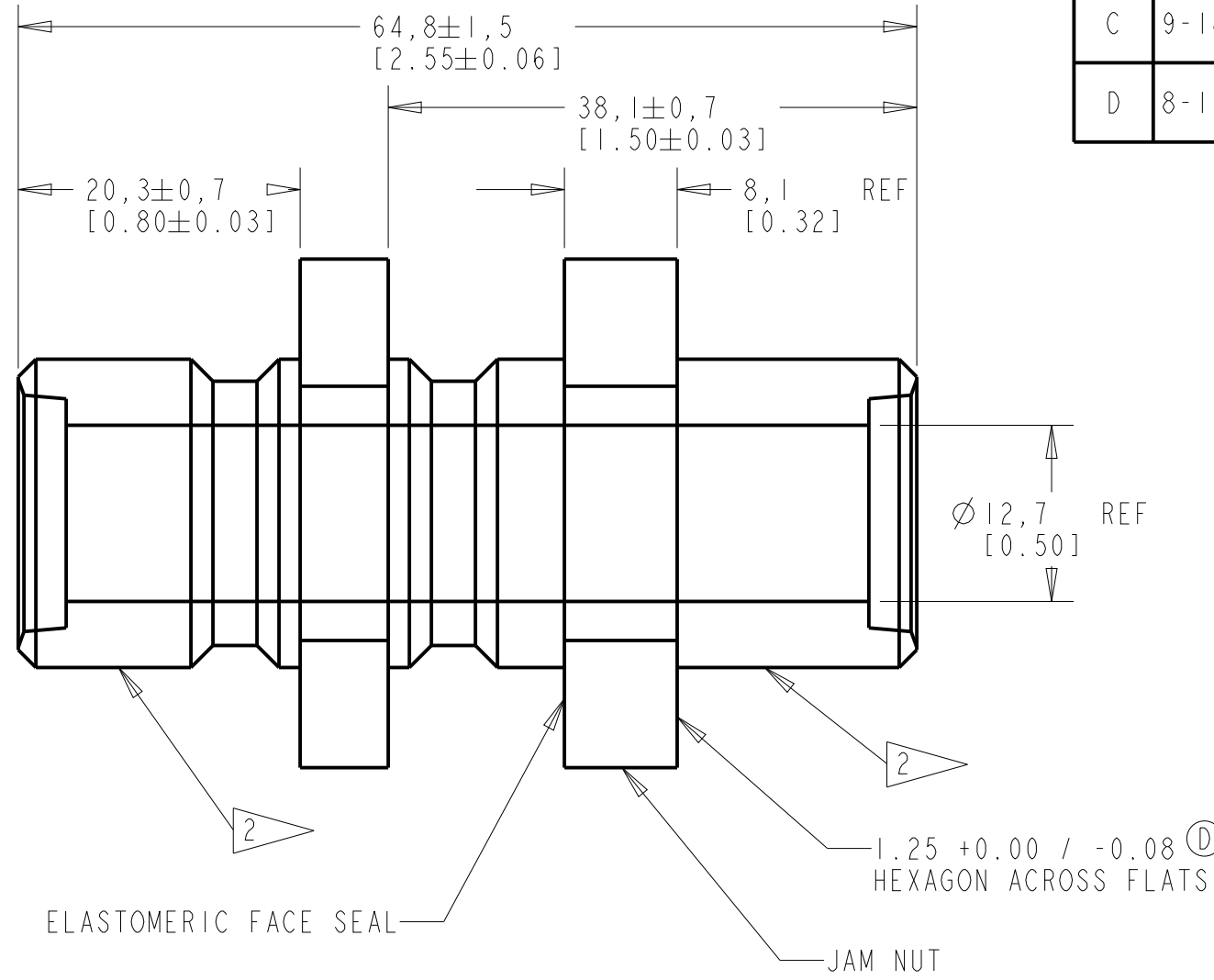

- Ⓓ 4) FITTING TO BE FREE FROM DEFECTS, DAMAGE AND CONTAMINATES PER ES-162
- Ⓓ 3) ALL INTERIOR AND MATING SURFACES MUST BE A MINIMUM OF 128

- 2) FITTING TO BE CAPPED BOTH ENDS
- 1) PENN TEX INDUSTRIES PART NUMBER PMC 1783 FOR -0,
RD-5-8774-1 FOR -1

- 2 #10 MALE O-RING WITH 7/8-14-2A THD PER IMACA 305 BOTH ENDS
- 1 12L14 COLD ROLLED STEEL ZINC III CLEAR

NOTE:

-0 SHOWN

-1 SHOWN

✓	✓	ITEM	PART NO.	DESCRIPTION	MAT'L	FINISH
-1	-0	DWN A. WHITFORD	9-28-00	#10 BULKHEAD FTG MULTI		US/UK
		CKD RICH O.	10-3-00			
SCALE: 2.00						
RED DOT CORPORATION 495 Andover Park East Seattle, WA 98188				THIS PRINT IS PROPRIETARY INFORMATION LOANED SUBJECT TO RETURN UPON DEMAND AND IS NOT TO BE USED DIRECTLY OR INDIRECTLY IN ANY WAY DETRIMENTAL TO RED DOT CORPORATION		
			NEXT ASSY MULTI	DWG. NUMBER RD-5-8774	SIZE B	SHEET 1 of 1

TOLERANCES EXCEPT AS NOTED

0. MM	+ 1.5 MM
0. INCH	+ .06 INCH
0. MM	+ .75 MM
0.00 INCH	+ .03 INCH
0.00 MM	+ .25 MM
0.00 INCH	+ .010 INCH
ANGULAR	± 0.5 DEG